

# XY2CZ708

Telemecanique Emergency stop rope pull switches XY2C, pulley for cable Ø 5 mm maximum, for XY2C

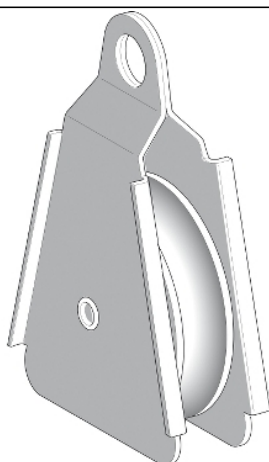

## Main

Range of product	Telemecanique Emergency stop rope pull switches XY2C
Accessory / separate part designation	Pulley for cable Ø 5 mm maximum
Accessory / separate part type	Pulley
Accessory / separate part category	Separate parts
Accessory / separate part destination	Emergency stop rope pull switch

## Complementary

Product compatibility	XY2CE XY2CH
Net weight	0.002 kg

## Packing Units

Unit Type of Package 1	PCE
Number of Units in Package 1	1
Package 1 Height	2.5 cm
Package 1 Width	5.5 cm
Package 1 Length	8.0 cm
Package 1 Weight	55.0 g
Unit Type of Package 2	S01
Number of Units in Package 2	40
Package 2 Height	15.0 cm
Package 2 Width	15.0 cm
Package 2 Length	40.0 cm
Package 2 Weight	2.57 kg

## Offer Sustainability

Sustainable offer status	Green Premium product
Environmental Disclosure	 <a href="#">Product Environmental Profile</a>
Circularity Profile	No need of specific recycling operations
California proposition 65	WARNING: This product can expose you to chemicals including: Diisononyl phthalate (DINP), which is known to the State of California to cause cancer, and Di-isodecyl phthalate (DIDP), which is known to the State of California to cause birth defects or other reproductive harm. For more information go to <a href="http://www.P65Warnings.ca.gov">www.P65Warnings.ca.gov</a>
For all Reach Rohs enquiries contact us at	<a href="mailto:sustainability@tesensors.com">sustainability@tesensors.com</a>

## Contractual warranty

Warranty	18 months
----------	-----------

---

Dimensions

---

